

# Clean Water ~ Green Spaces



## Rural and Agricultural Landowner Grants

## Water Quality & Natural Areas Restoration Grant Program



# Clean Water ~ Green Spaces Water Quality Enhancement & Natural Areas Restoration Program

## Eligibility Guidelines

### You May Qualify for Funding

Grants are available to landowners to implement projects which will help improve local water quality, reduce soil erosion, and increase natural areas cover. The following grant rates and maximums apply to all projects. A \$90.00 per acre minimum cash contribution is required for all tree planting projects (not including Buffer strips and wind breaks). **All projects must be pre-approved before work is started.**

Eligible Projects	Grant Rate <sup>1,5</sup>	Maximum Grant	Staff Contacts 519-776-5209 Fax: 519-776-8688
Buffer strips and wind breaks <sup>2</sup>	Up to 75%	\$3,000	Michael Dick ext 369 <a href="mailto:mdick@erca.org">mdick@erca.org</a>
Tree planting <sup>2,3</sup> Blocks of up to 5 acres (2 hectares)	Up to 75%	\$5,000	Robert Davies ext 310 <a href="mailto:rdavies@erca.org">rdavies@erca.org</a>
Tree planting <sup>2,3</sup> Blocks larger than 5 acres (2 hectares)	Up to 90%	no maximum	Paul Giroux ext 377 <a href="mailto:pgiroux@erca.org">pgiroux@erca.org</a>
Soil erosion control structures (e.g., rock chutes, header tile retrofits, etc.)	Up to 75%	\$3,000	Michael Dick ext 369 <a href="mailto:mdick@erca.org">mdick@erca.org</a>
Water Well capping	Up to 50%	\$1,500	Michael Dick ext 369 <a href="mailto:mdick@erca.org">mdick@erca.org</a>
Septic system upgrades <sup>4</sup>	Up to 33%	\$5,000	Michael Dick ext 369 <a href="mailto:mdick@erca.org">mdick@erca.org</a>

<sup>1</sup> In kind landowner contributions are eligible for tree planting, buffer strip, and wind break projects larger than 1 acre (0.4 hectare), and soil erosion control structures. In kind landowner contributions are ineligible for all other projects.

<sup>2</sup> All projects must include a minimum of 500 native trees or shrubs.

<sup>3</sup> A minimum \$90.00 per acre contribution applies for block tree planting projects.

<sup>4</sup> **Septic system upgrades** are only available in the **Detroit River watershed** (includes the Canard River, Turkey Creek and Little River watersheds – grant rate 33%, up to a maximum of \$5,000).

See attached watershed map on page 10.

<sup>5</sup> All projects applying for Environmental Farm Plan grants will be funded at a 50% rate.

## Program Guidelines

To qualify for funding the following criteria must be met:

- Project types must fall into one of the categories noted in the table above.
- Projects must demonstrate an improvement to local surface water and/or groundwater quality and/or result in an increase in natural areas cover.
- The landowner must demonstrate good land stewardship practices.
- The landowner must contribute financially to the project (see table above).
- The landowner must complete a Clean Water ~ Green Spaces Project application form.
- Other grant programs (e.g., Environmental Farm Plan) can be used to top up ERCA's Clean Water ~ Green Spaces Program. Total grant dollars cannot exceed the cost of the project.

## How to Apply for Grants

- Obtain specific program information from ERCA to determine if your project qualifies.
- Complete a Clean Water ~ Green Spaces application form.
- A site visit from ERCA staff will be necessary to determine eligibility, and again following project completion. **Do not start your project until you have written approval from ERCA. Projects initiated prior to written approval are not eligible for the grant program.**
- Projects that will result in the best benefits to water quality and fish and wildlife habitat will be prioritized for funding.
- All applications will be reviewed by an Evaluation Committee.

# Clean Water ~ Green Spaces Water Quality & Natural Areas Restoration Grant

## Eligibility Criteria

### Tree plantings

#### **Project Details**

- in kind costs can be included as eligible expenses only if the project retires at least one acre (0.4 hectare) of cultivated farmland
- all projects must include a minimum of 500 trees or shrubs.
- a \$90.00 per acre minimum cash contribution is required for all tree planting projects (not including Buffer strips and wind breaks).
- accepted tree planting practices will apply for all applications (e.g., appropriate site preparation, spacing, etc.)
- seedling trees only will be funded (not large stock or potted stock)
- preference will be given to those applications that take into consideration wildlife habitat and the creation/joining of wildlife corridors
- only native species are eligible
- tree plantations that retire fragile land will be given preference over applications that are not on marginal lands
- preference will be given to those projects that incorporate a maintenance program e.g. mowing
- grant amount will not exceed the cash costs to the landowner plus pre-approved in kind contributions for labour and machinery as per Eligible Expenditure Guidelines (see attached)

#### **Eligible project costs will include:**

- design, plant material and labour costs
- tree protection systems (guards, etc.)
- in kind labour and machinery costs based on attached Eligible Expenditure Guidelines for projects larger than 1 acre (0.4 hectare)

#### **Ineligible costs (expenses not covered by a grant):**

- commercial stock, Christmas tree, fruit tree or other species which are economically marketable in less than 10 years
- in kind land value
- all in kind contributions on projects retiring less than 1 acre (0.4 hectare) of cultivated farmland

### Windbreaks

#### **Project Details**

- in kind costs can be included as eligible expenses only if the project retires at least one acre (0.4 hectare) of cultivated farmland
- all projects must include a minimum of 500 trees or shrubs.
- accepted tree planting practices will apply for all applications (e.g., appropriate site preparation, spacing, etc.)
- a distance of not less than 1 meter will be left between the tree row and the cultivated crop. Distances of less than 1 meter at any point in the row will result in the Seedling Survival Guarantee being null and void.

- the landowner agrees to leave marker flags in the tree row for a minimum of 3 years. Removal will result in the Seedling Survival Guarantee being null and void.
- the landowner agrees to implement a regular maintenance program of mowing on each side of every row. Failure to have mowed by July 15 will result in the Seedling Survival Guarantee being null and void.
- seedling trees only will be funded (not large stock or potted stock)
- preference will be given to those applications that take into consideration wildlife habitat and the creation/joining of wildlife corridors
- native species will be planted unless such species are not suitable for the application
- preference will be given to windbreaks in combination with buffers that are at least 9 metres (30 feet) in width and consist of multiple tree rows and diverse species
- tree plantations that retire fragile land will be given preference over applications that are not on marginal lands
- grant amount will not exceed the cash costs to the landowner plus pre-approved in kind contributions for labour and machinery as per Eligible Expenditure Guidelines (see attached)

**Eligible project costs will include:**

- design, plant material and labour costs
- tree protection systems (guards, etc.)
- in kind labour and machinery costs based on attached Eligible Expenditure Guidelines for projects larger than 1 acre (0.4 hectare)

**Ineligible costs (expenses not covered by a grant):**

- commercial stock, Christmas tree, fruit tree or other species which are economically marketable in less than 10 years
- in kind land value
- all in kind contributions on projects retiring less than 1 acre (0.4 hectare) of cultivated farmland

**Buffer Strips**

**Project Details**

- in kind costs can be included as eligible expenses only if the project retires at least one acre (0.4 hectare) of farmland
- buffers must be a minimum of 1.5 metres (5 feet) in width
- preference will be given to those buffers that are 3 metres (10 feet) or wider with 9 metres (30 feet) or more given highest priority
- buffers can be combined with other projects e.g. rock chutes.
- grant amount will not exceed the cash costs to the landowner plus pre-approved in kind contributions for labour and machinery per attached Eligible Expenditure Guidelines for projects larger than 1 acre (0.4 hectare)

**Eligible project costs will include:**

- design, plant material and labour costs of buffer strips
- tree protection systems (guards, etc)
- in kind labour and machinery costs based attached Eligible Expenditure Guidelines for projects larger than 1 acre (0.4 hectare)

**Ineligible costs (expenses not covered by a grant):**

- commercial stock, Christmas tree, fruit tree species or other species which are economically marketable in less than 10 years
- in kind land value
- all in kind contributions on projects retiring less than 1 acre (0.4 hectare) of cultivated farmland

**Soil Erosion Control Structures (e.g. Rock Chutes)**

**All projects must be pre-approved before work is started.**

**Project Details**

- only structures that reduce soil erosion from agricultural fields will be funded.
- all rock chutes must be installed according to accepted practices e.g., gabion rip rap stone with a filter fabric layer, appropriate slopes, etc. Please refer to Rock Chute Installation sheet.
- preference will be given to those applications that incorporate a buffer and/or windbreak
- liaison with the municipal Drainage Superintendent is recommended and may be required
- grant amount will not exceed the cash costs paid by the landowner plus pre-approved in kind contributions for labour and machinery, **based on a maximum cost of \$5.00/sq.ft. of finished rock chute.**

**Eligible project costs will include:**

- professional design, labour, material and equipment
- in kind labour and machinery cost per attached Eligible Expenditure Guidelines.

**Ineligible costs (expenses not covered by a grant):**

- in kind land value
- any costs involving new or re-tiling including header lines.

**Abandoned Water Well Plugging**

**All projects must be pre-approved before work is started.**

**Project Details**

- wells must be plugged by a Ontario Ministry of the Environment licenced well contractor
- projects must comply with Ontario Ministry of the Environment procedures for plugging an unused water well according to Ontario Regulation 903; details of the procedure must be documented on an Ontario Ministry of the Environment Water Well Record and a copy submitted to ERCA.

**Eligible project costs will include:**

- licensed contractor fees
- labour and material associated with proper well plugging procedures

**Ineligible costs (expenses not covered by a grant):**

- labour and machinery costs other than those of a licensed contractor
- in kind contributions

## **Septic System Upgrades**

**All projects must be pre-approved before work is started.**

### **Project Details**

- **only available in the Detroit River watershed (includes the Canard River, Turkey Creek and Little River watersheds) – see map on page 10.**
- a septic system is comprised of the septic tank, and the leaching bed. Upgrades of this system may be required if your system is improperly designed, has been poorly maintained, or there are leaks or overloading occurring from your system
- **upgrades as part of a directive, for example, septic systems that are required as part of a lot severance or septic systems that must be upgraded as part of an order from the local municipality , the Windsor-Essex County Health Unit, or the Ministry of the Environment, are NOT eligible for the grant program**
- **new homes/additions are NOT eligible**
- grants are limited and are issued on a first come basis
- any septic system that demonstrates some sort of direct connection or discharge to a watercourse as determined by a visual inspection will be given preference for funding assistance
- contact your municipality to obtain a permit for construction on your septic system when applying for the grant (permits are the landowner's responsibility)
- septic system upgrades must comply with the Ontario Building Code
- projects must be completed by a Certified Septic System Installer
- at least two written estimates from Certified Installers must be included with each application

### **Eligible project costs will include:**

- licensed contractor costs

### **Ineligible costs (expenses not covered by a grant):**

- labour and machinery costs other than those of a licensed contractor

**Clean Water ~ Green Spaces Program**  
**In Kind Landowner Contributions**  
**Eligible Expenditure Guidelines**

The rates included in the table below should be used by landowners when calculating their in-kind contributions to projects. Information on whether your project qualifies for in-kind contributions is outlined in the *Eligibility Guidelines* section of the application package. Rates are based on Ontario Ministry of Agriculture, Food and Rural Affairs Custom Rate Schedule and Essex Region Conservation Authority Fee Schedule.

<b>Project Type</b>	<b>Activity</b>	<b>Specifications</b>
Rock Chutes	Backhoe	Up to \$75/hour (includes equipment & operator)
	Excavator	Up to \$130/hour (includes equipment & operator)
	Rock	\$20/ton (including trucking)
Tree Planting/ Buffer Strip/ Windbreak	Ploughing	Minimum \$90 or \$21/acre (includes operator)
	Discing or Roto tilling	Minimum \$124 or \$11/acre (includes operator)
	Broadcast seeding	Minimum \$113 or \$3/acre (includes equipment & operator)
	Drill seeding	Minimum \$211 or \$21/acre (includes equipment & operator)
	Pasture seed mix	\$2/lb at 10 to 35 lbs/acre
	Clover seed	\$1.50/lb at 8 to 15 lbs/acre
	Tree planting	\$0.50/seedling
	Spraying rows of trees (pre-emergent herbicide)	\$0.15/seedling (includes chemical, equipment & operator)
	Site burn down (Pull type sprayer) (broad spectrum herbicide)	Minimum \$217 or \$8/acre (includes chemical, equipment & operator)
Mowing between rows of trees	\$15/acre (based on 2-3 times/year for 2 years) (includes equipment & operator)	

# Sample Location Map

Property Owner: \_\_\_\_\_

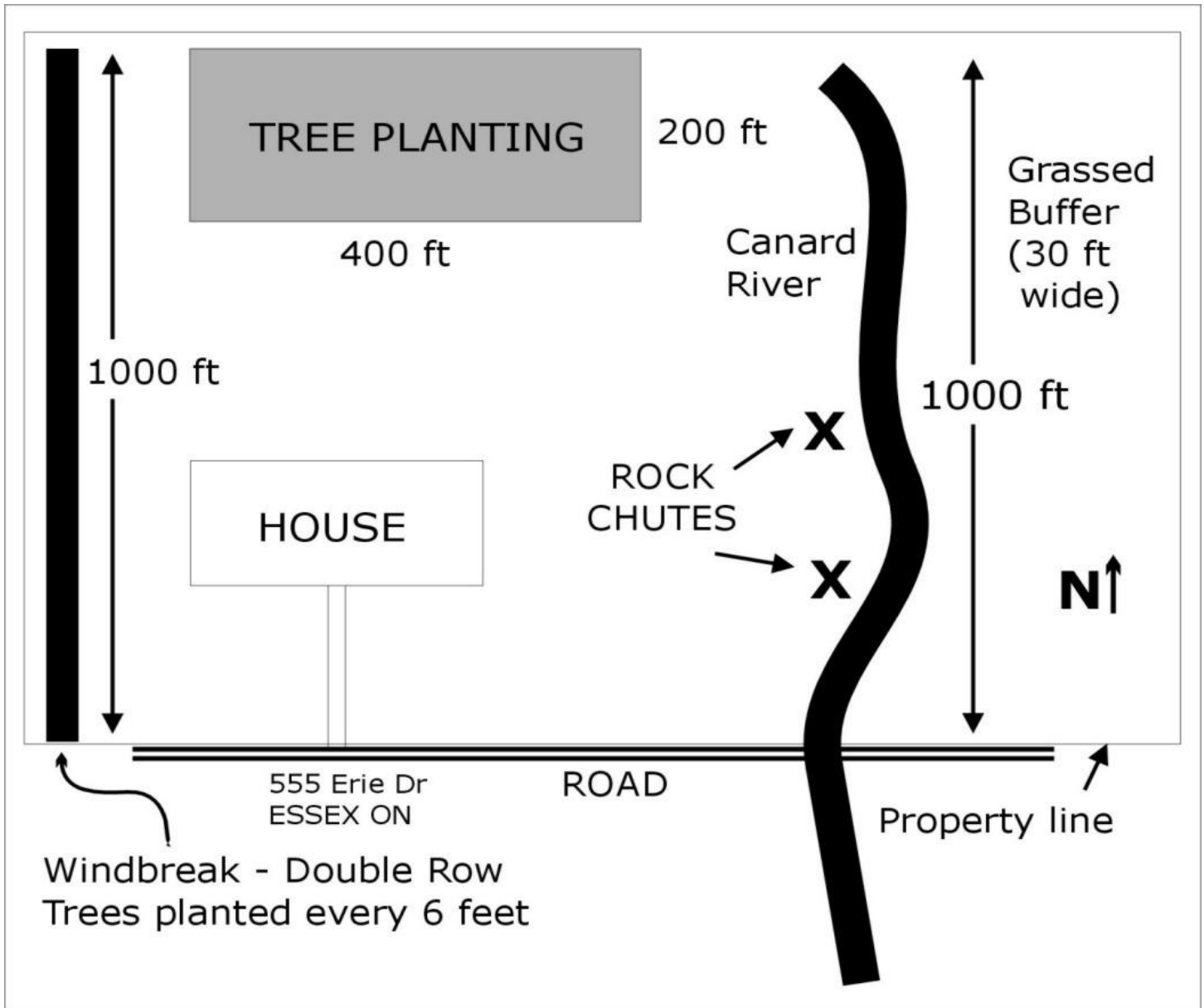

Please make a sketch drawing of the proposed project outlining the road, the land marks on the property (barns, house, etc.) and the 911 of the nearest dwelling.

Note location of proposed project works.

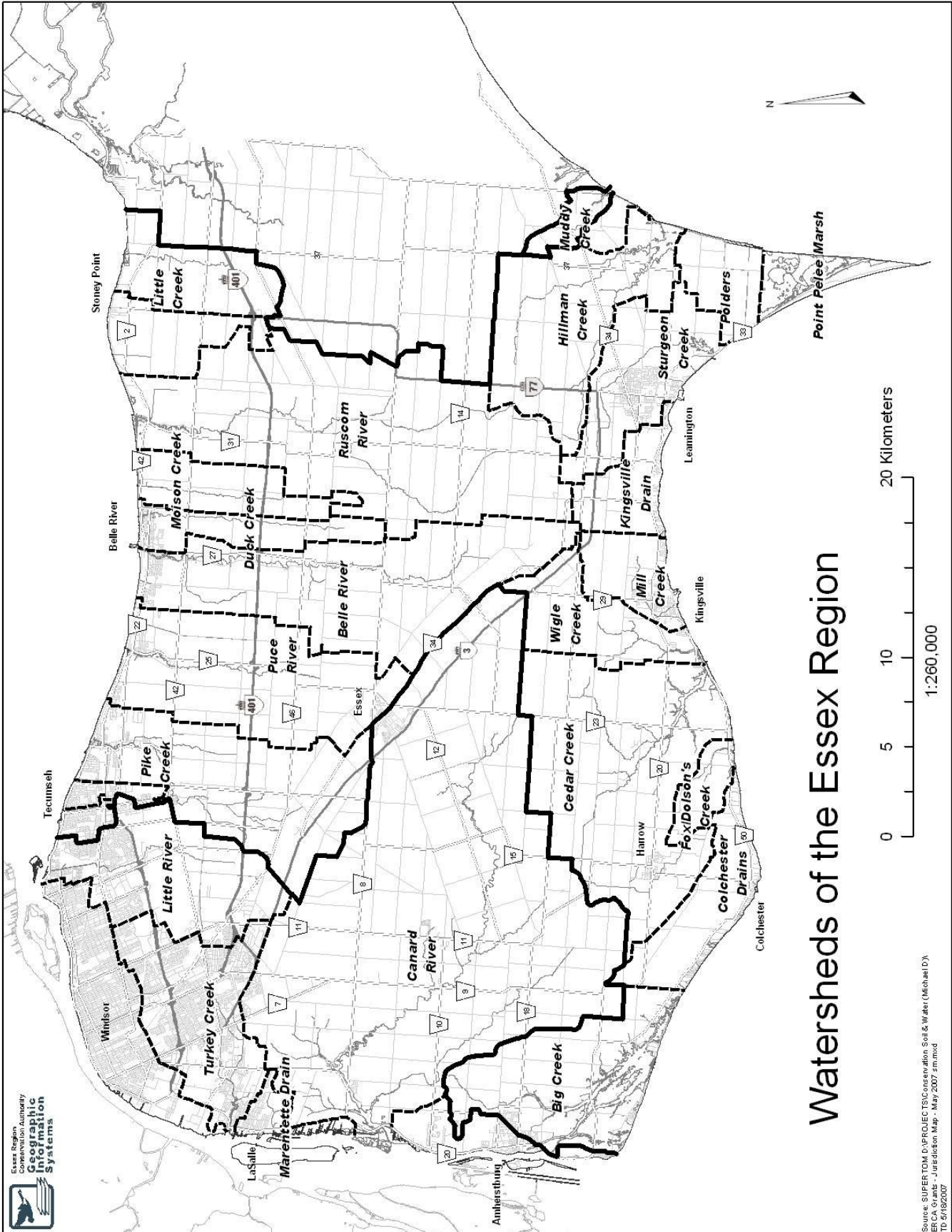

# Watersheds of the Essex Region

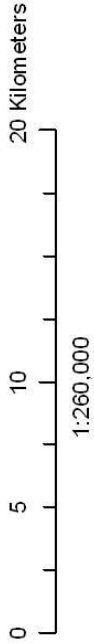

Source: SUPER.TOM.D.V.PROJECTS/Conservation Soil & Water (Michael D.Y.)  
 ERCA Grants - Jurisdiction Map - May 2007 sm.mod  
 TD: 5/18/2007